

Proposed Tower Section A-A

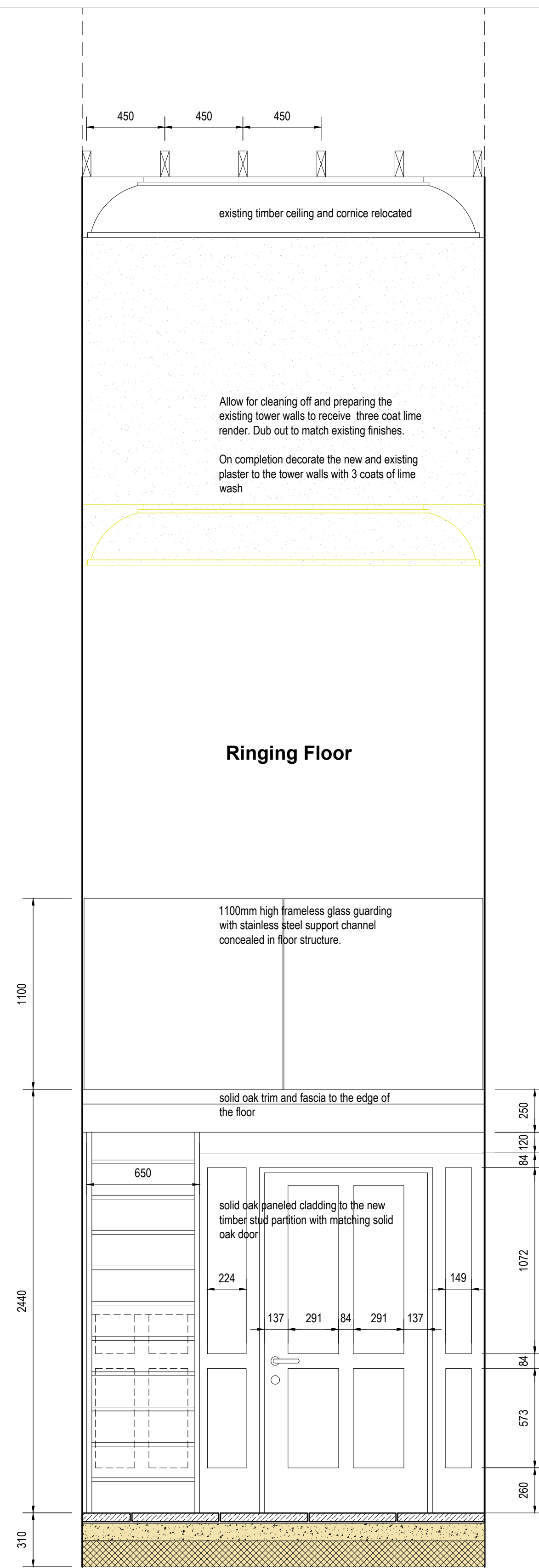

Proposed Tower Elevation

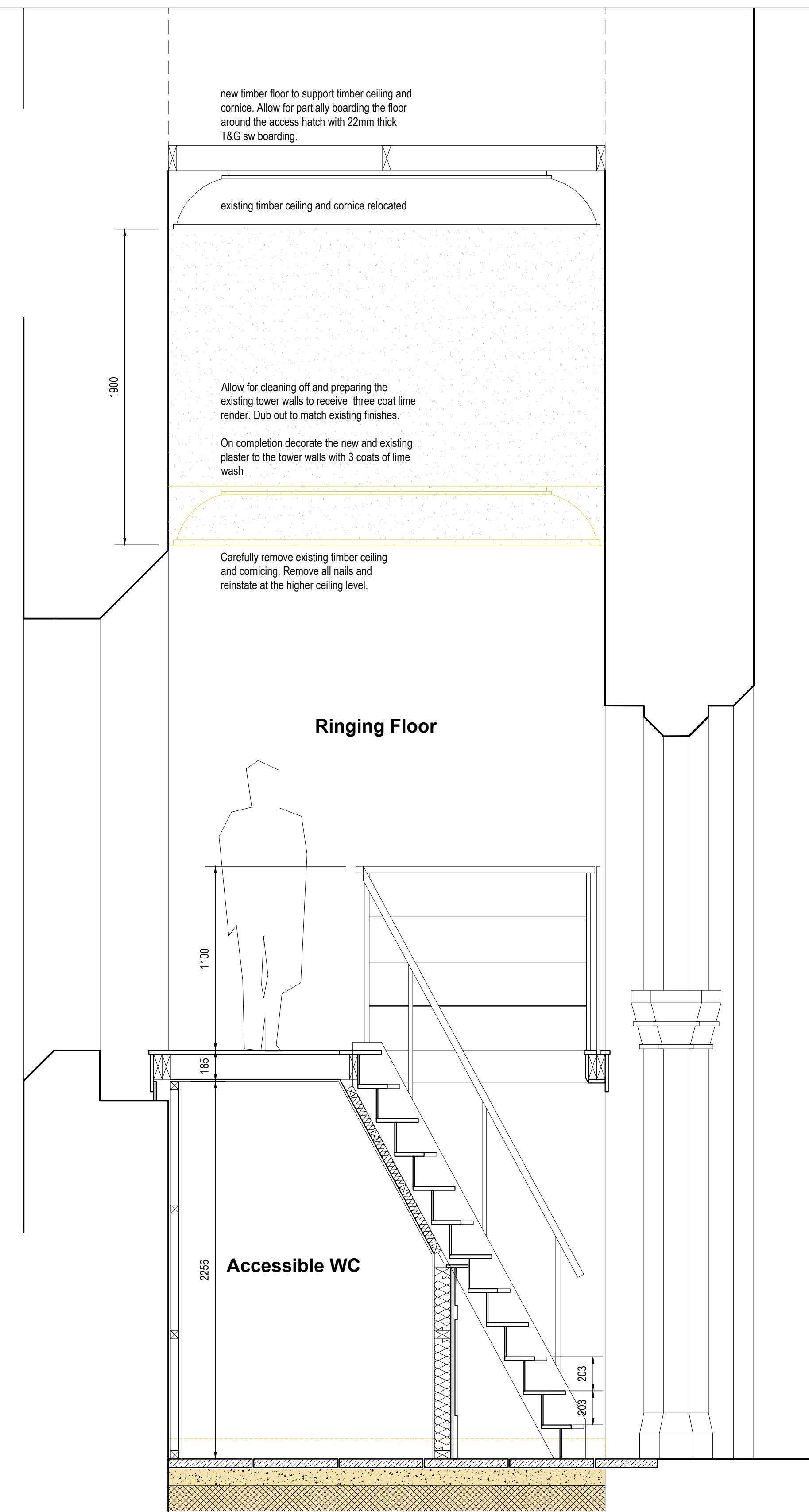

Proposed Tower Section B-B

St John's Church, Scampton

REVISION/DRAWN	DATE	DESCRIPTION	SCALE	A1	1:20	DATE	MAY20
CLIENT	Scampton PCC						
PROJECT	St John the Baptist - Reordering						
TITLE	Proposed Tower Sections						
REFERENCE	9101	CHECKED				254	
T:	01909 500710						
E:	contact@soularchitects.co.uk						
W:	www.soularchitects.co.uk						

soul architects

© ALL RIGHTS RESERVED. REPORT ALL DISCREPANCIES PLEASE DO NOT SCALE. CHECK ALL DIMENSIONS ON SITE. REGISTERED IN ENGLAND AND WALES. REGISTERED ADDRESS: SOUL ARCHITECTS LIMITED 13 SPARKENHILL, WORKSOP, NOTTINGHAMSHIRE, S80 1AA. COMPANY NO. 0599863